

TIMELINE

- 
- March/April, 2020: Traffic Counts, website release, landowner meetings
 - May/June: updated Interstate Justification Report/EA/Utility Mtgs/Prelim Design
 - July/Aug: EA/Utility Exploration/Preliminary Design/30% Plans & Cost Estimate
 - September 1: Phase 1 Grant Agreement Approved
 - Sept/Oct: Release Draft EA at public on-line meeting/Finalize ROW/Plan Design
 - Nov/Dec: Finalize EA/Meet with Landowners/**60% Plans & Cost Estimate**
 - 2021: Finalize Plans/Acquire ROW/Purchase Wetland Mitigation/90% Cost Estimate
 - Sept 2021: Anticipated Bid Letting Date
 - 2022/2023: Anticipated Construction

****Normally a 4 year time frame**

Alternate 5 Recommended in EA

Alternative Considerations

- Avoids golf course impacts.
- Southwest quadrant loop and ramp require property acquisitions.
- Minimizes impacts to east side properties.

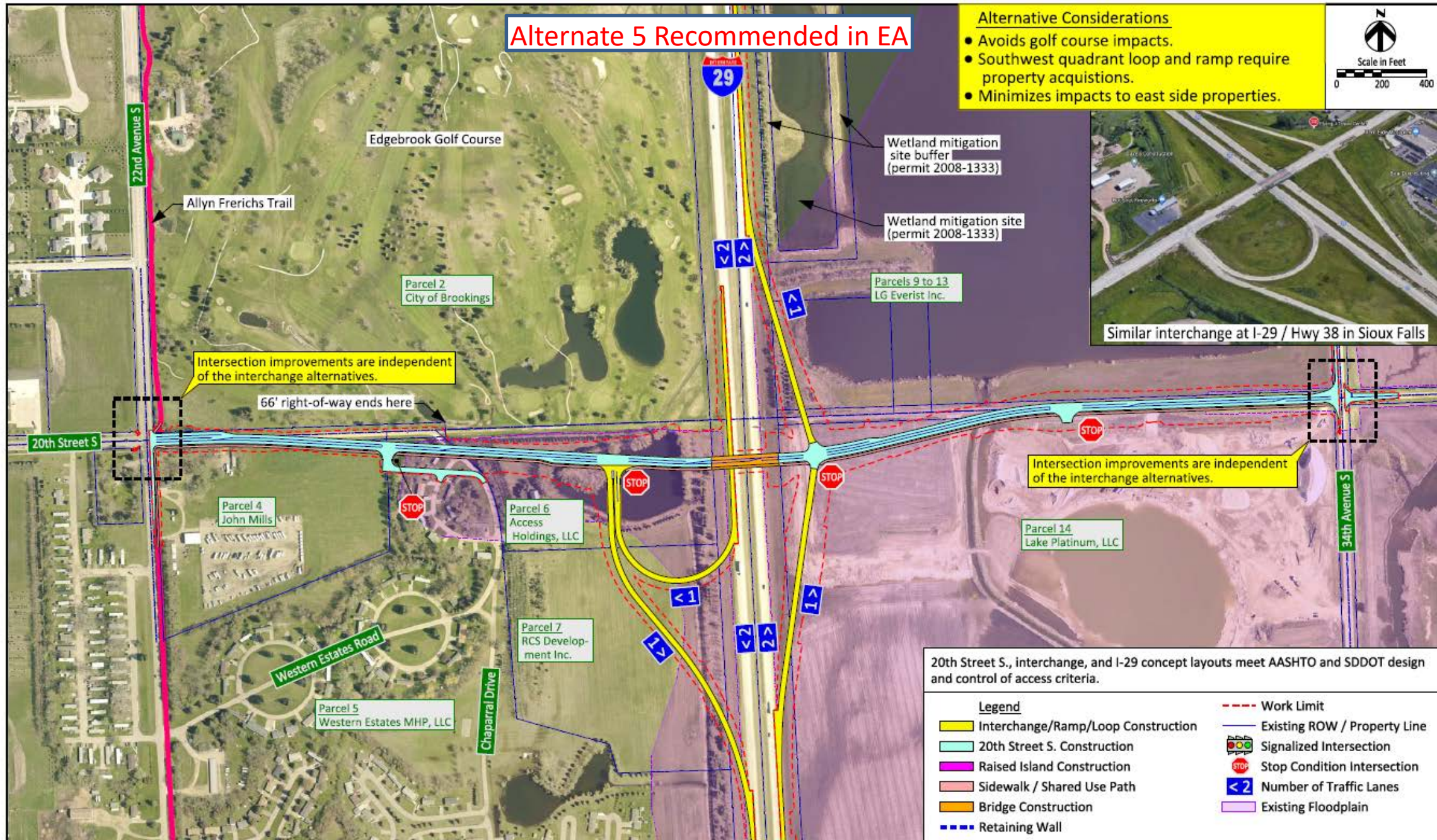
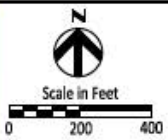

Similar interchange at I-29 / Hwy 38 in Sioux Falls

20th Street S., interchange, and I-29 concept layouts meet AASHTO and SDDOT design and control of access criteria.

Legend

- | | |
|---|---|
| Interchange/Ramp/Loop Construction | --- Work Limit |
| 20th Street S. Construction | --- Existing ROW / Property Line |
| Raised Island Construction | Signalized Intersection |
| Sidewalk / Shared Use Path | Stop Condition Intersection |
| Bridge Construction | <2 Number of Traffic Lanes |
| --- Retaining Wall | Existing Floodplain |

Drawn By: B. Miller
Date: 4/17/2020
Chkd By: J. Unruh
Date: 4/17/2020
Revision: 9/29/2020



Concept Layout
Alternate 5 - Single Loop Interchange
I-29 Exit 130 (20th Street S) Interchange PCN 020V

STREET LIGHTS

- **20th St S Design:**
30' tall light poles,
8' arm, LED, 140' spacing
- **City to provide power to street lights and perform maintenance**
- **SDCL 49-34A-57:**
service to utility's own property or facilities

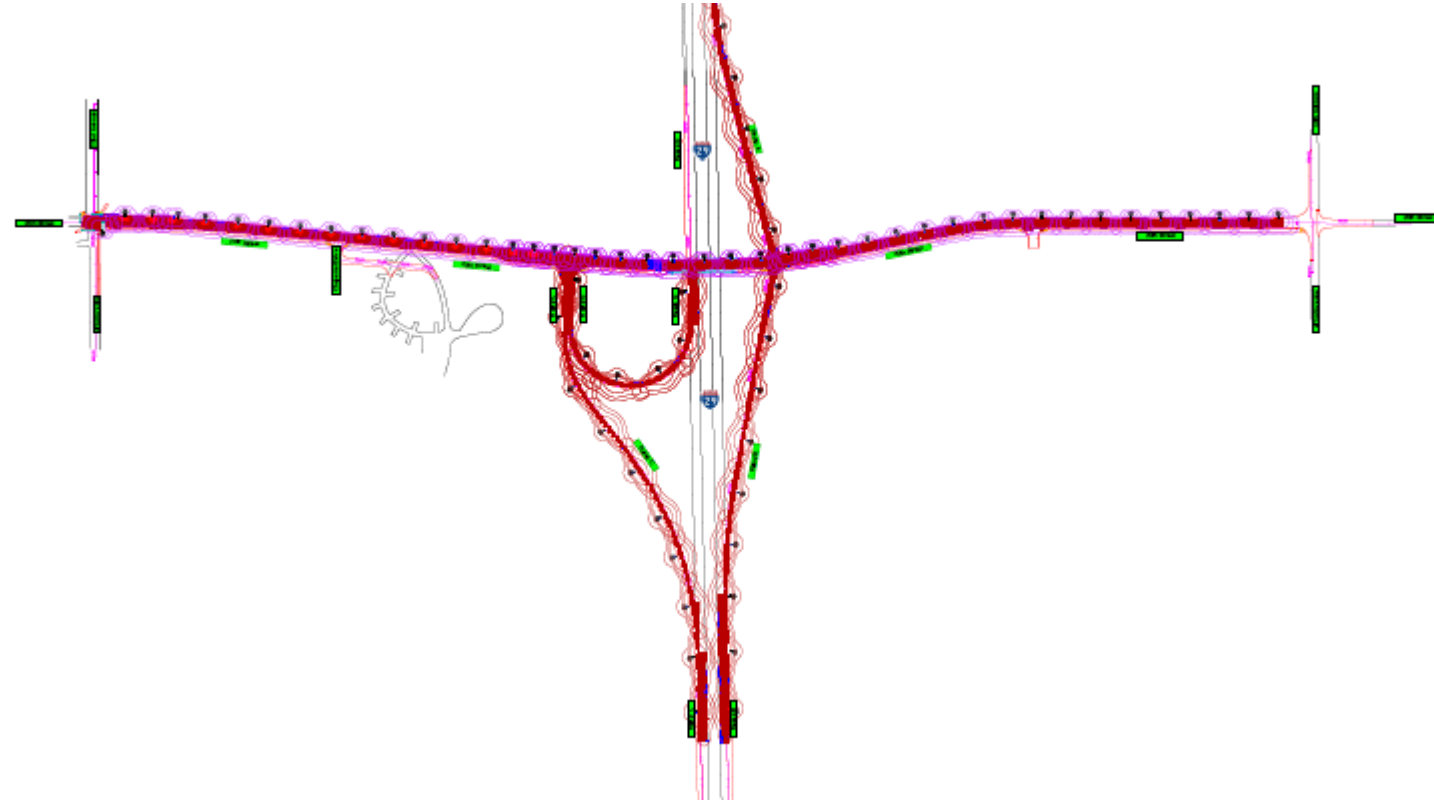

20th Street South Interchange Project

TASK	GRANT APP	30% Estimate	60% Estimate	90% Estimate
Design/ROW/DOT Costs/Utility Relocation	▪ \$1,912,639	▪ \$2,826,284	▪ \$2,826,284	
Wetland Mitigation	▪ \$186,090	▪ \$186,090	▪ \$186,090	
Construction Administration (DOT)	▪ \$1,604,063	▪ \$1,604,063	▪ \$1,604,063	
Construction Costs (Asphalt)*	▪ \$19,644,245	▪ \$18,193,035	▪ \$18,354,703	
Construction Costs (Concrete)*	▪ \$19,644,245	▪ \$18,536,885	▪ N/A	
Total Estimate with Asphalt	▪ \$23,347,037	▪ \$22,809,472	▪ \$22,971,140	
Total Estimate with Concrete	▪ \$23,347,037	▪ \$23,153,322	▪ N/A	

*Only one pavement type will be bid

NEXT STEPS

- Compile comments and responses on EA, finalize EA document, submit for approval
- Respond to landowners on their questions and access options
- Continue Design, 90% cost estimate in approx. Feb. 2021
- Project is meeting the grant schedule
- Project Website:
www.20thstinterchange.com

