



630 6TH AVE

404550050000800

0.012 acres

32.04

24.48

20.58

25.52

16.67

5.267

20.08

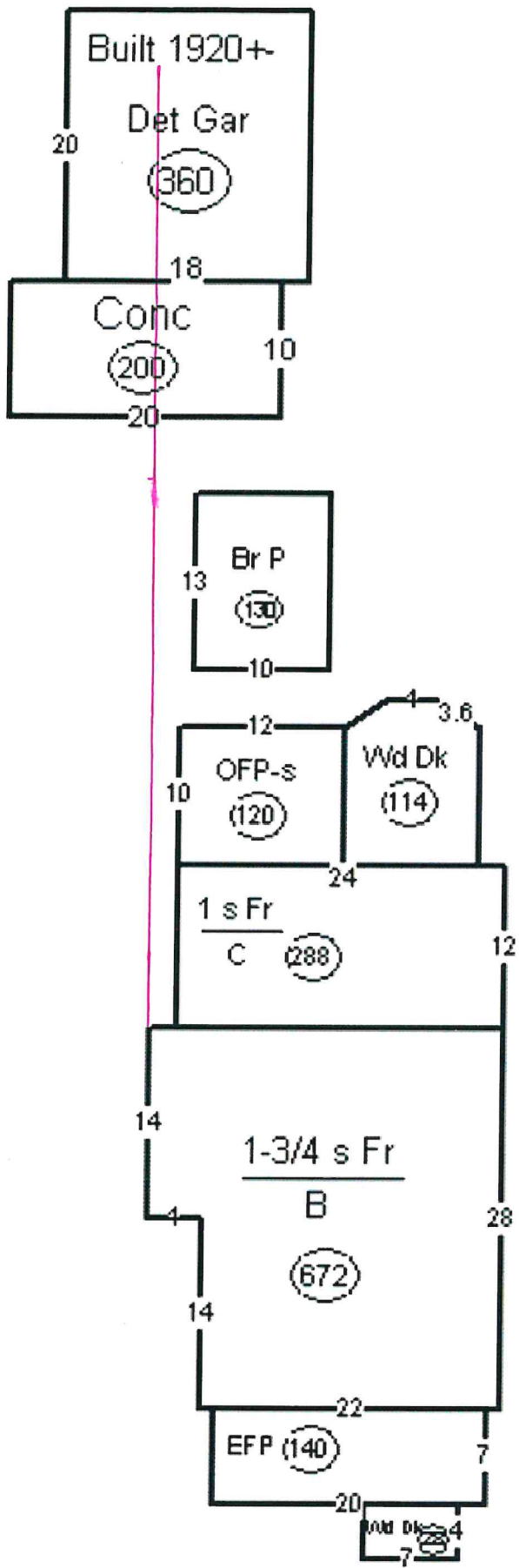

630 6th Ave, Brookings, SD 57006

Variance request notes.

The pink line shown on the aerial and plan views of the property show the east/west plain of the property which is 12' 5" from the south side of the sidewalk to the north of the property (7th St). It is requested that the variance be granted to permit the building of a garage the north side of which could be as far north as the pink line shown.

An indication of the approximate location of the new garage is outlined in red on the aerial view of the property. This image also shows a 5' setback at the south and a 20' setback at the east (10' setback plus 10' concrete driveway).