

Landscape Plan

NOTES:
 Surfaced Area: 40,500 SF
 Parking Area: 35,900 SF
 14 Trees Required

SITE LEGEND

- Proposed Foundation Planting
(Consisting of Shrubs, Perennials
and Native Grasses)
- Proposed Deciduous Tree
(2" Caliper)

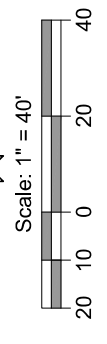
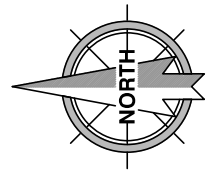

REGISTERED PROFESSIONAL ENGINEER
 REG. NO. 104400
PRELIMINARY
 SOUTH DAKOTA
 LAND SURVEYOR

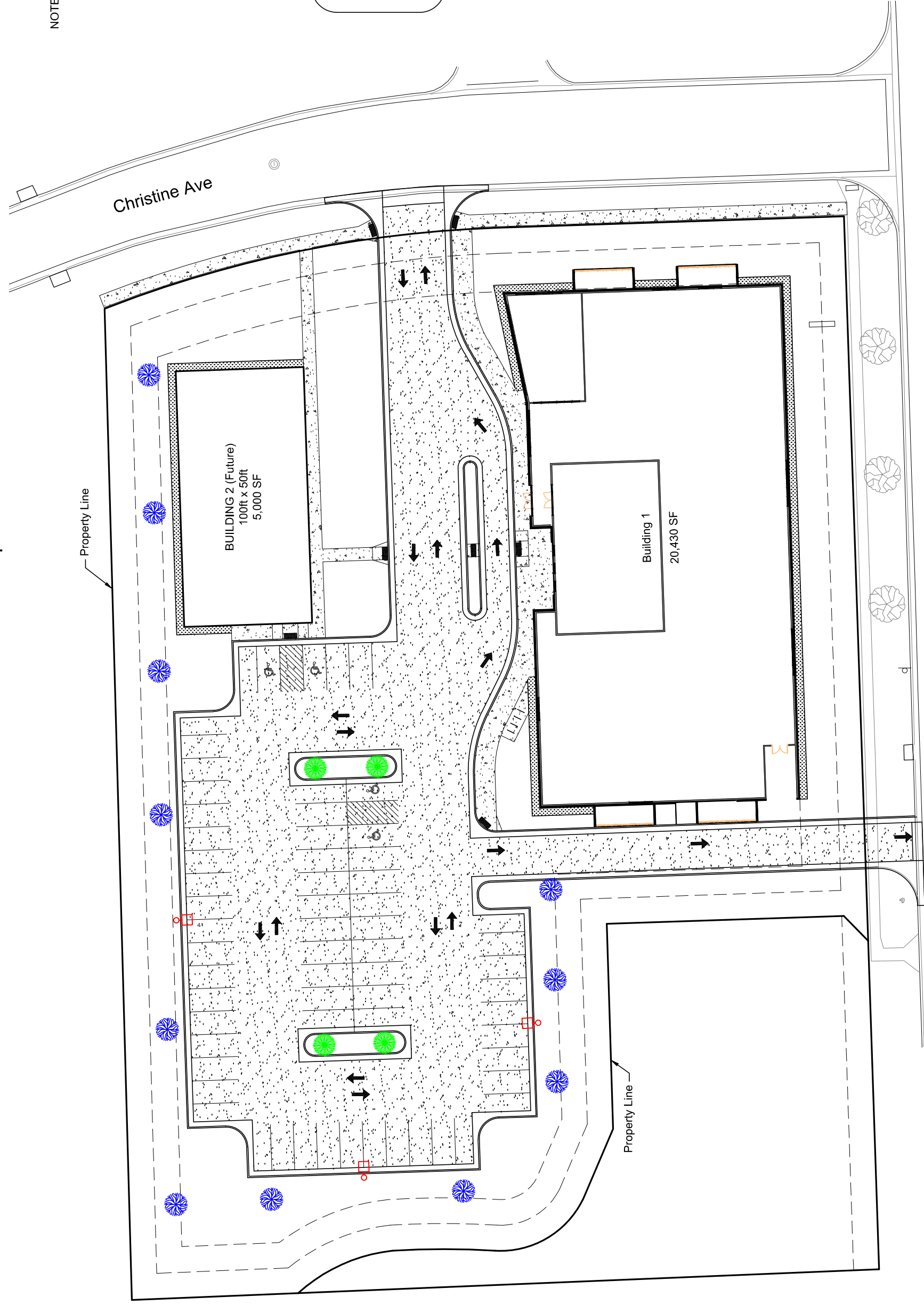

20th St S

BOOP THE SNOOT

CAD Filename: Preliminary Design

CDI Project No. 2024-088

Drawn By: JMD

Checked By: AEK

Scale: 1" = 40'

Date: 06/28/2024

609 Main Ave S
 Brookings, SD
 605-696-3200

CDI CIVIL DESIGN INC

Sheet No: 2 of No: 2

Brookings\Projects\2024-088 RWF - Vet Site Design\Design\Preliminary Design\2024-088 RWF Preliminary Design Option 3.dwg, Landscape Plan, 7/22/2024 11:21 AM, Jesse Ursetad