

This list will be updated before contractor begins work

Updated: 3-28-24

House Number	Address	Names	Roots	Water Valve	Remove	Install	Completed
101	Lincoln Ln	Matthew & Emily Sass	YES	NO	50.0	50.0	
102	8th St	Daniel Biefeldt	NO	NO	25.0	25.0	
112	W 7th St	Bryan Norton	YES	NO	50.0	50.0	
117	17th Ave	Diane Owens	YES	NO	25.0	25.0	
125	6th St	Aman Enterprises LLC	YES	NO	50.0	50.0	
209	7th St	DAS Properties Inc.	NO	NO	50.0	50.0	
221	16th Ave S	James & Cynthia Juntunen	YES	NO	25.0	25.0	
221	17th Ave	College Town Rentals LLC	YES	NO	50.0	50.0	
303	7th St	Daniel & Nancy Christie	YES	NO	50.0	50.0	
305	Lincoln Ln S	Troy Ness	NO	NO	25.0	25.0	
311	21st Ave S	Prairie Wind Properties LLC	NO	YES	25.0	25.0	
315	Eastern Ave S.	Shelon Surat & Nathan Harrington	YES	NO	25.0	25.0	
321	8th St	George & Julie Hamer	YES	NO	25.0	25.0	
324	12th Ave	Michael Rysavy	NO	NO	25.0	25.0	
324	21st Ave S	Todd & Julie Gunderson	YES	NO	25.0	25.0	
330	21st Ave S	Darrell & Sherry Eiseman	NO	YES	25.0	25.0	
400	State Ave	Sean O'Neill	NO	NO	25.0	25.0	
405	20th Ave	Christopher Anderegg	YES	NO	25.0	25.0	
405	Ohio Dr	Kyle Gutomson	NO	NO	50.0	50.0	
405	State Ave	Christopher & Erin Bauman	YES	NO	175.0	175.0	
410	11th Ave	Kaufman Family Trust, Toby & Elaine Kaufman	YES	NO	25.0	25.0	
416	Ohio Dr	Michael & Kim Kilber	NO	YES	25.0	25.0	
417	Harvey Dunn St	Sioux Empire Development Corp	NO	NO	25.0	25.0	
423	8th St	Fishback Patricia Revocable Trust	NO	NO	25.0	25.0	
425	11th Ave	Christopher & Amy Harris	YES	NO	25.0	25.0	
428	State Ave	Cindy Chamley	YES	NO	25.0	25.0	
517	7th St	DAS Properties Inc.	YES	NO	50.0	50.0	
603	Harvey Dunn St	LGW Investments LLC	YES	YES	25.0	25.0	
607	12th Ave	Tyler & Matthew Morog	NO	NO	50.0	50.0	
620	11th Ave	Nesta Enterprises LLC	YES	NO	25.0	25.0	
620	Hughes Ave	Brian & Lynn Damall	NO	NO	50.0	50.0	
621	8th St	David Aaron & Virginia Conger	YES	NO	25.0	25.0	
628	Faculty Dr	Jerakine Rogers	NO	NO	25.0	25.0	
711	7th St	Mark Kelsey	YES	NO	25.0	25.0	
715	2nd Ave	Grace & Jody Peterson	NO	NO	25.0	25.0	
715	7th Ave	Carolyn Clague	NO	NO	25.0	25.0	
715	8th Ave	Charles & Kimberly McCullough	YES	NO	50.0	50.0	
719	8th Ave	Jason Schuetz and Michael & Dawn Tvedt	YES	NO	25.0	25.0	
726	Henry Ave	David & Delona Pedersen	YES	NO	75.0	75.0	
729	11th Ave	Rabbit Rentals 729 LLC	NO	NO	50.0	50.0	
803	6th St	Trappor & Emilee Masson	NO	NO	25.0	25.0	
804	6th Ave	Matthew & Melissa Otteson	YES	NO	25.0	25.0	
811	7th Ave	Clark & Lyla Hanson	YES	NO	25.0	25.0	
902	7th St	Vickie Vanderwal	YES	NO	25.0	25.0	
902	9th St	Eric & Anna Tellekson	YES	NO	25.0	25.0	
1025	5th St	Waylon Waite & Amy Yost	YES	NO	25.0	25.0	
1202	3rd St	Sharon Palo	NO	NO	125.0	125.0	
1210	2nd St	Cody & Inessa Anderson	NO	NO	25.0	25.0	
1226	Camelot Dr	Tyrel Kissner	Yes	YES	100.0	100.0	
1345	1st St	Bruce & Ellen Pengra	NO	NO	25.0	25.0	
1403	2nd St	Colburn Family Trust, Duane and Eunice Colburn	YES	NO	50.0	50.0	
1409	1st St	Martin & Kimberly Steineke	NO	NO	25.0	25.0	
1409	3rd St	Judy Alickson	YES	YES	50.0	50.0	
1603	7th St	Susan Rosenberg	YES	NO	25.0	25.0	
1605	6th St	HART2HART Inc	NO	NO	25.0	25.0	
1630	Elmwood Dr	Brett Behrends	NO	NO	50.0	50.0	
1631	Olwien St	56552 Properties LLC	YES	NO	25.0	25.0	
1702	6th St	Cokato INC	NO	NO	25.0	25.0	
1721	3rd St	Thomas & Marleen Bozied	YES	NO	25.0	25.0	
1814	Terrace Dr	David & Patricia Meyer	YES	NO	25.0	25.0	
1819	Olwien St	Spencer & Linda Vaa	NO	NO	50.0	50.0	
1907	Olwien St	Lynanne Gries & Matt Gorder	NO	NO	25.0	25.0	
1923	Spyglass Hill Dr	Owen & Jessica Myhre	NO	YES	100.0	100.0	
2003	Elmwood Dr	Kirsi Moody	YES	NO	75.0	75.0	
2006	1st St	Oscar & Sarah Hernandez	YES	YES	75.0	75.0	
2010	Derdall Dr	Max Pinkava & Megan Nelson	NO	NO	50.0	50.0	
2011	Elmwood Dr	Susan Colby	YES	NO	25.0	25.0	
2021	Derdall Dr	Tom Hammink	YES	NO	25.0	25.0	
2022	Derdall Dr	William Bruns	YES	NO	50.0	50.0	
2024	1st St	Leonard & Norita Henneman	YES	NO	50.0	50.0	
2044	Morningside Dr	Michael & Brenda Andersen	YES	NO	50.0	50.0	
2050	Morningside Dr	Angela Thayer	NO	NO	25.0	25.0	
2105	Derdall Dr	Carly Holmstrom & Kyle Larson	YES	NO	50.0	50.0	
2122	Olwien St	Ronda Schulte	YES	NO	25.0	25.0	
2206	Rio Grande Ave	Jessica Callahan & Brock Blocker	NO	YES	25.0	25.0	

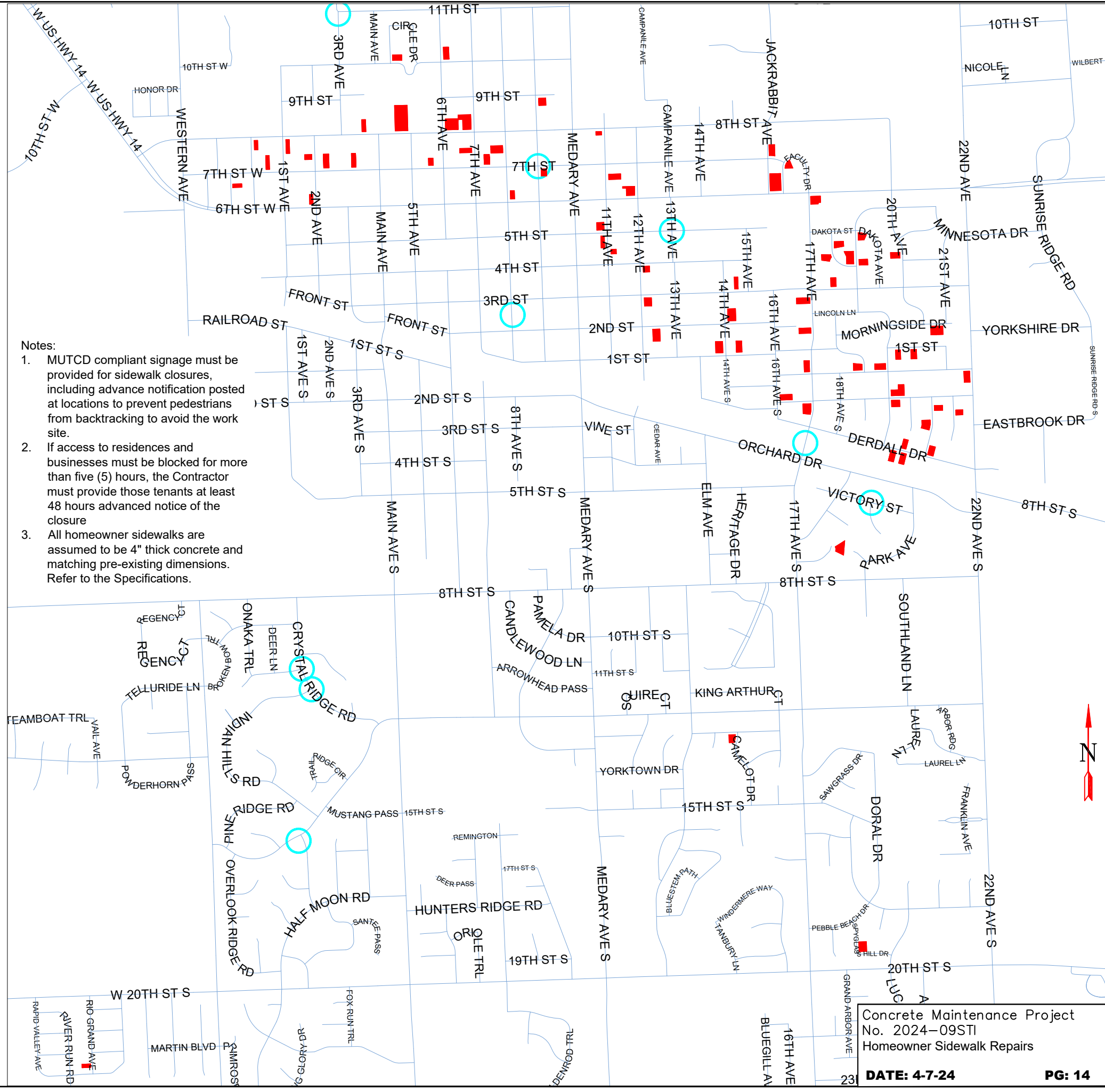

- Notes:
1. MUTCD compliant signage must be provided for sidewalk closures, including advance notification posted at locations to prevent pedestrians from backtracking to avoid the work site.
 2. If access to residences and businesses must be blocked for more than five (5) hours, the Contractor must provide those tenants at least 48 hours advanced notice of the closure
 3. All homeowner sidewalks are assumed to be 4" thick concrete and matching pre-existing dimensions. Refer to the Specifications.

Concrete Maintenance Project
 No. 2024-09STI
 Homeowner Sidewalk Repairs